

**Step 5**

Connect wall panel zip to the roof and base zips starting (under Velcro flaps).

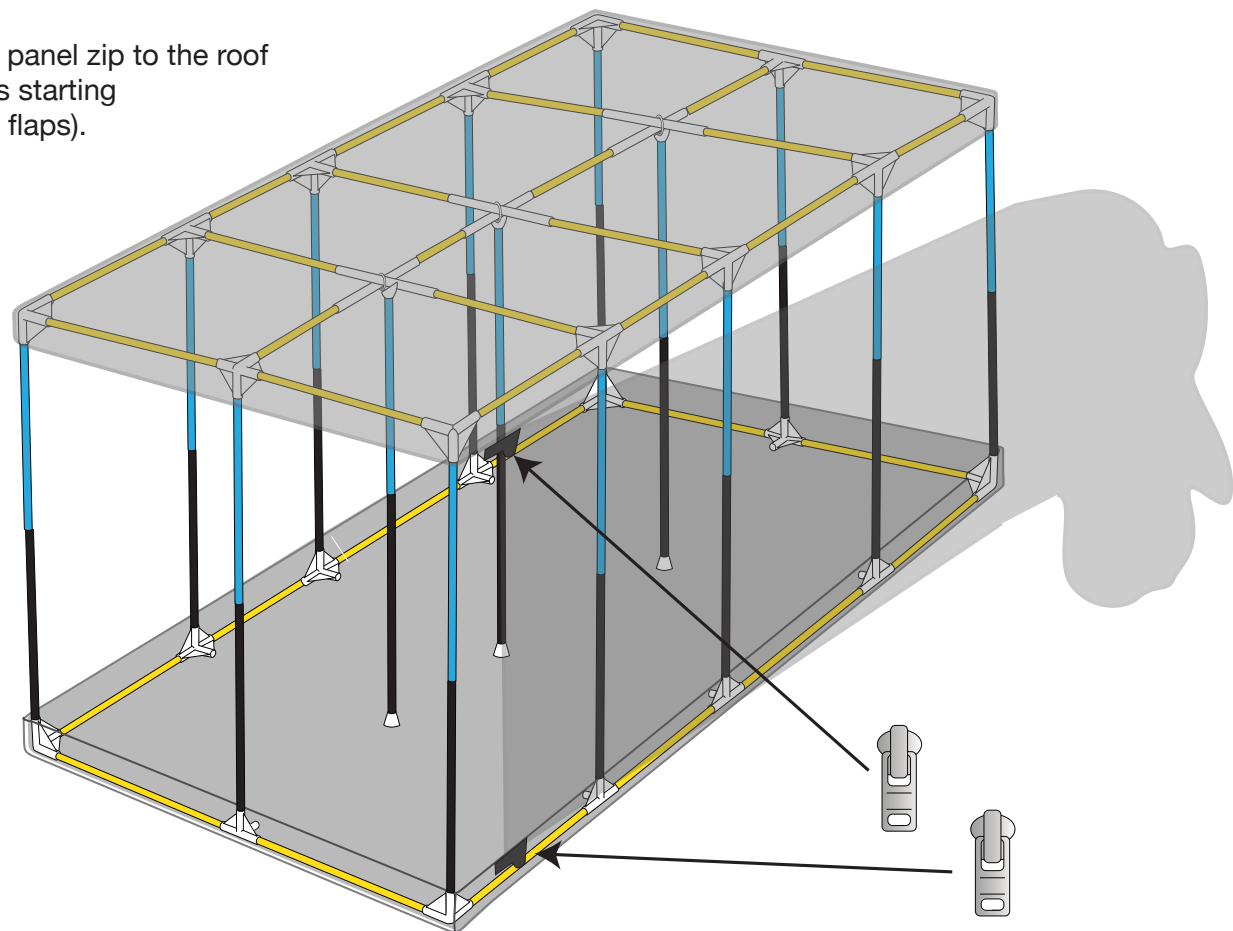

**Step 6**

Zip the wall panel to the roof and base. Fit equipment hanger ends to poles. Position equipment hangers as required.

Equipment Hanger End

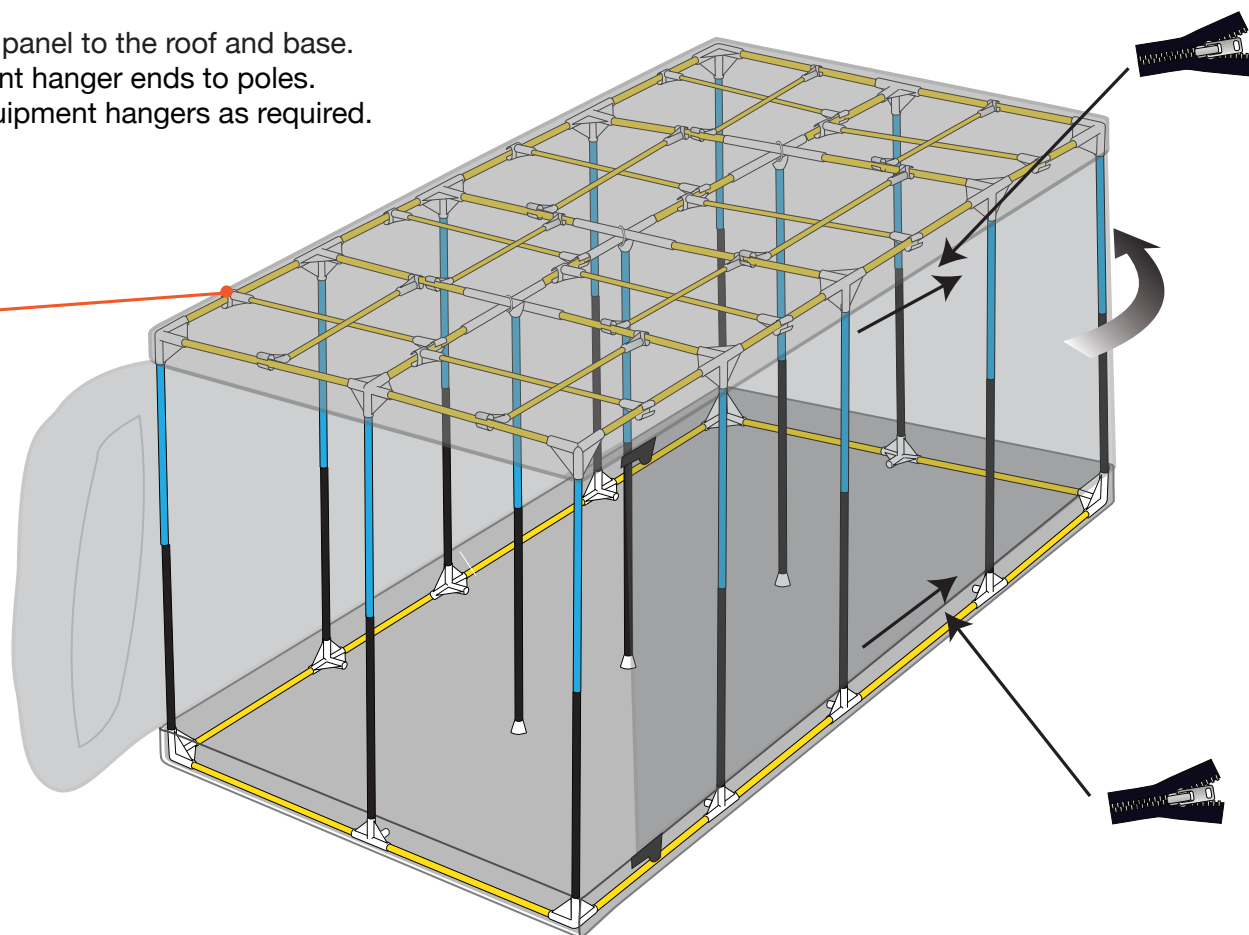
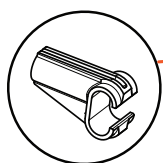

**Assembly Instructions**

Two Person Assembly

**Elite+HC 480L 600L**  
mammothtent.nl



**Mammoth  
Elite+HC 480L, 600L  
Assembly Guide**

Equipment Hangers



**Parts List**

- Yellow Pole x50
- Blue Pole x15
- Black Pole x15
- 3-Way Corner x8
- 4-Way Join x16
- Equipment Hanger Ends x32
- Support Pole Rubber Foot x3
- Support Pole Rubber Top x3
- Straight Pole Connectors x6
- Centre Securing Ring x3

### Step 1

Organise poles and connectors into their colours and groups.  
Unzip and lay out tent.  
Locate floor section and lay flat with edge sections vertical.  
Assemble floor poles and 3-way corners and 4-way Joins as shown.  
Ensure Velcro flap is in front right corner.

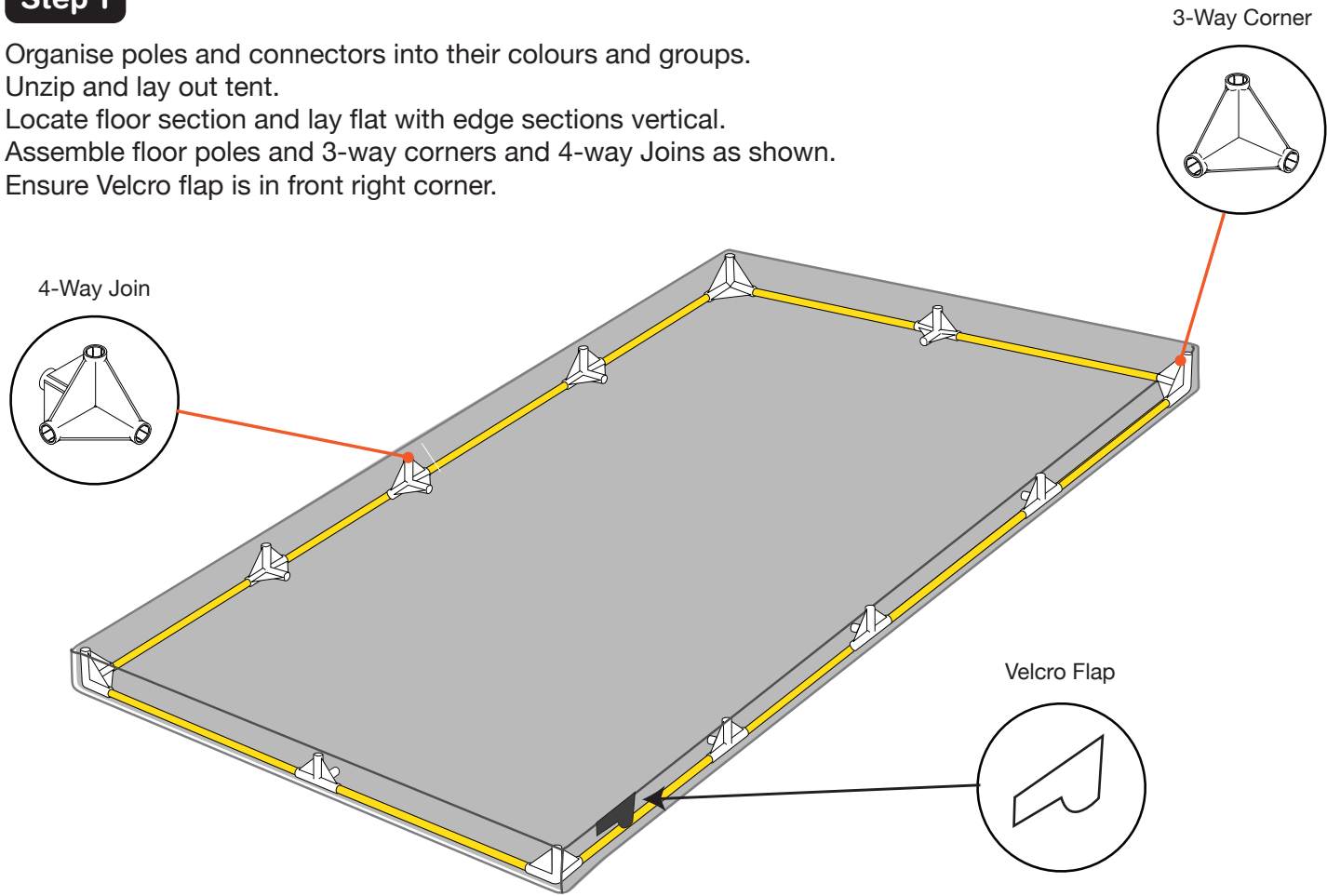

### Step 3

Insert ceiling poles into 3-way corners and 4-Way joins.  
Fit centre securing ring over pole before fitting to 4-way join.  
Fit centre ceiling poles into straight pole connectors.

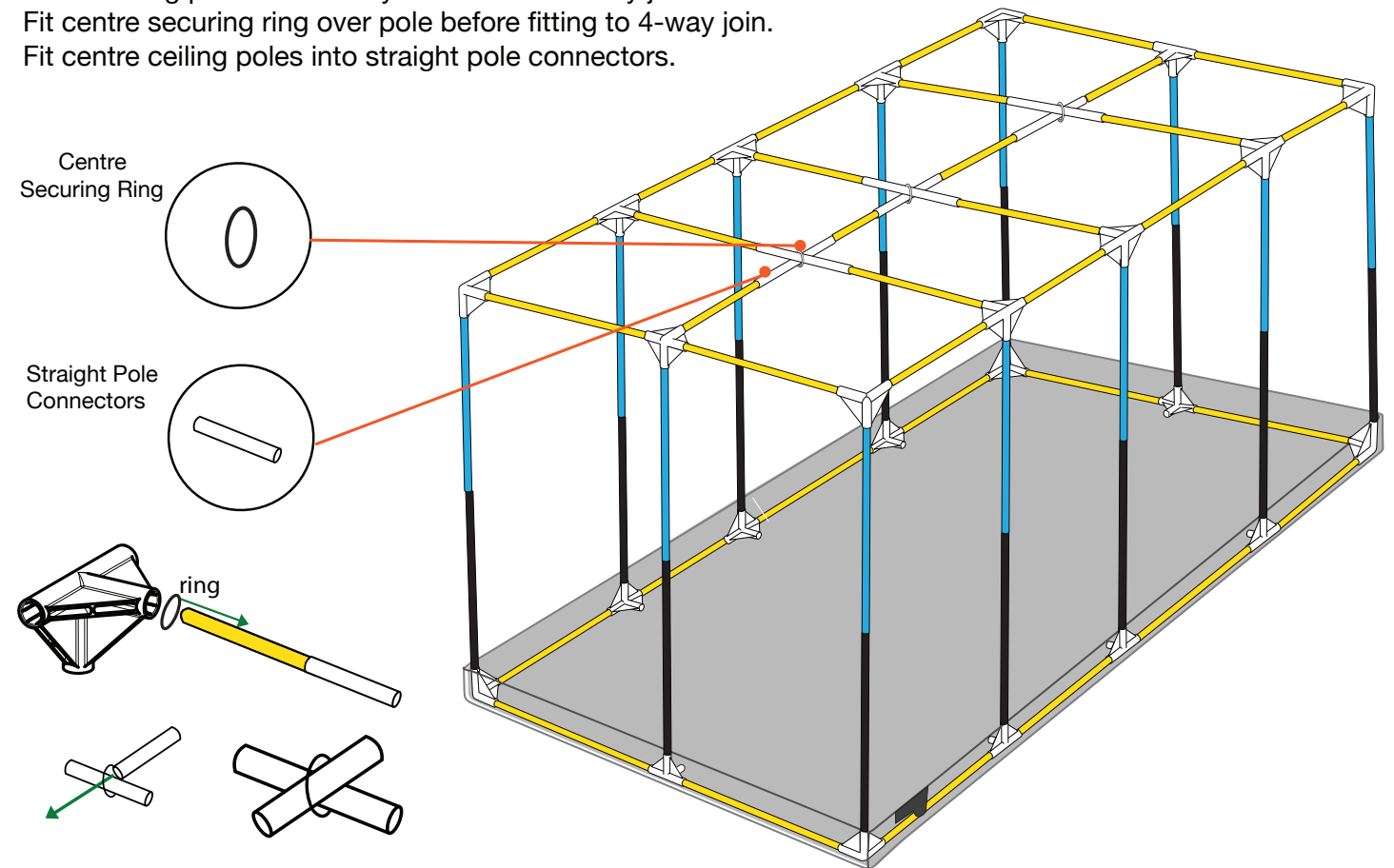

### Step 2

Insert lower wall poles (chamfered end) into 3-way corners and 4-way Join.  
Insert upper wall poles (shrunk end) into lower poles.  
Fit 3-way corners and 4-way joins on top.

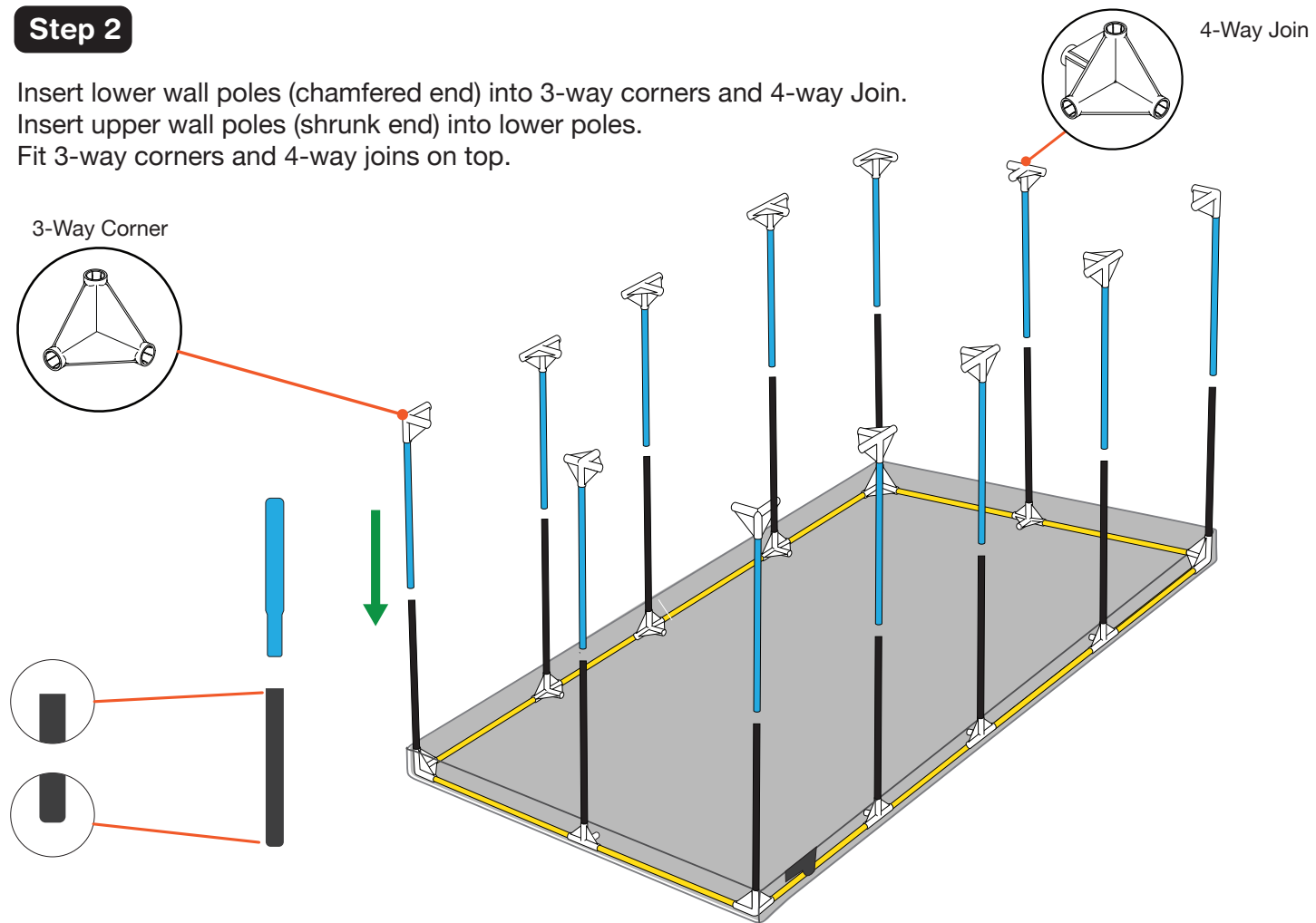

### Step 4

Fit support poles.  
Fit roof ensuring Velcro flap is in front right corner.

